

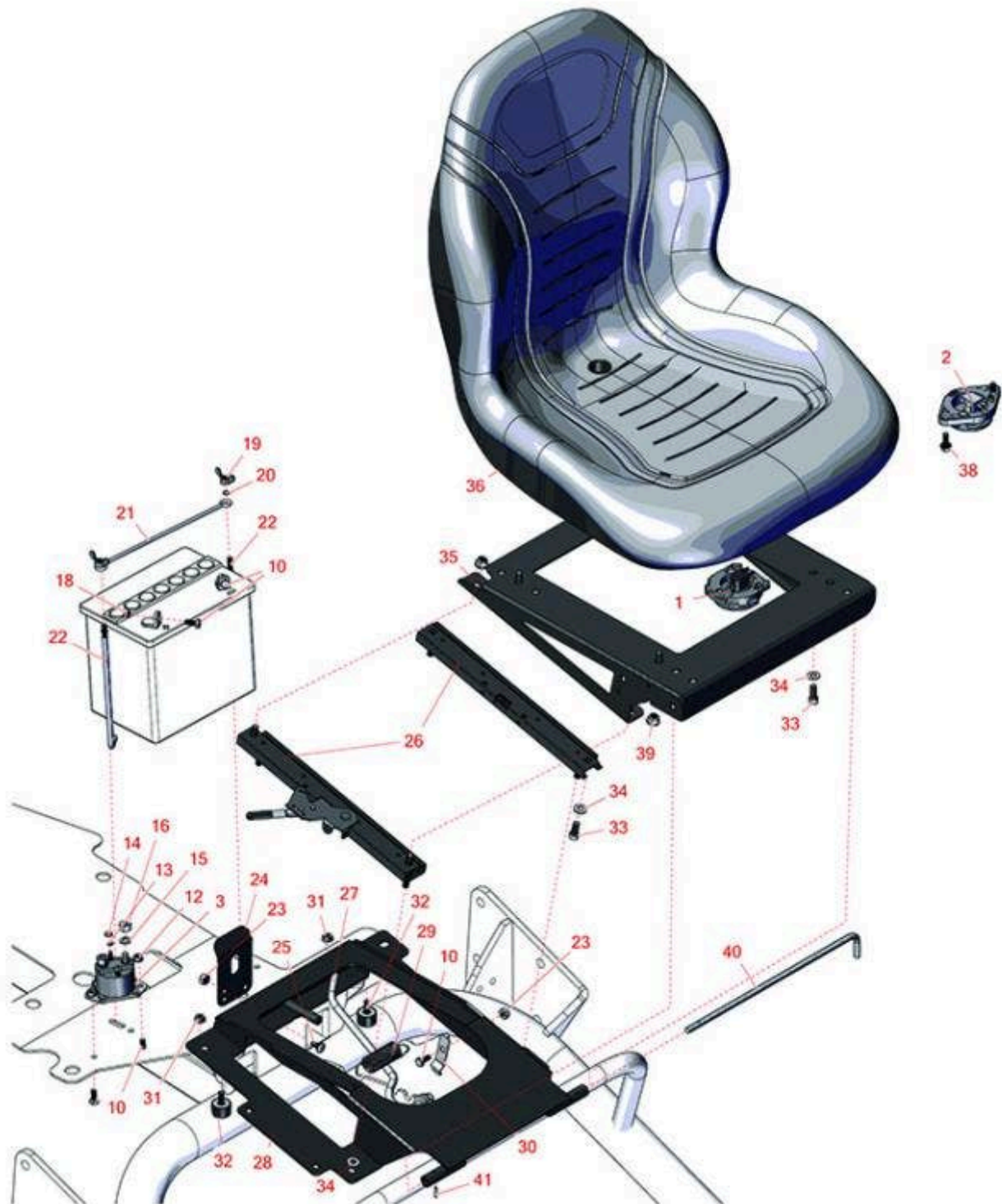

# Replaces R&R Products Greens Max 2200LP Parts

*Traction Unit  
Seat & Battery*



All original equipment manufacturers names and part numbers are used for identification purposes only, and we are in no way implying that our products are original equipment parts. Prices subject to change without notice.



# Replaces R&R Products Greens Max

## 2200LP Parts

Traction Unit  
Seat & Battery



Item No	R&R Part No.	OEM Part No.	Description	Qty Req	Order Quantity
---------	--------------	--------------	-------------	---------	----------------

### Gauges and Controls

1	<b>R151541</b>		Delta Seat Switch - Twist Mount 1 Pole Normally Open	0	
2	<b>R92-6282</b>	R554390, RAET10449	Switch - Kill - Seat	1	
3	<b>R28-4210</b>		Solenoid	1	

### Other Parts Available

10	<b>R400106</b>	R321-3, R513315, R908002P	Bolt - Hex HD 1/4-20 x 5/8	4	
12	<b>R32149-2</b>	R32128-11, R3290-158, R3290-23	Nut-Keps	2	
13	<b>R3254-1</b>	R19-0820, R33-7-FHD	Washer- Lock - Int	2	
14	<b>R444312</b>	R22-9-BJD, R26-2360, R26-4370, R3219-12, R3219-14, R48-9280, R513287, R915561	Nut - 10-32	2	
15	<b>R3253-4</b>	R01-166-0110, R01-166-0510, R09053, R23-10-GD, R24-7170, R30-8520, R42-9850, R48-9350, R48-9360, R48-9570, R68-9420, R99-7577	Washer - Lock 5/16 Zinc	2	

All original equipment manufacturers names and part numbers are used for identification purposes only, and we are in no way implying that our products are original equipment parts. Prices subject to change without notice.



# Replaces R&R Products Greens Max

## 2200LP Parts

*Traction Unit  
Seat & Battery*



Item No	R&R Part No.	OEM Part No.	Description	Qty Req	Order Quantity
16	<b>R3218-13</b>		Nut-Jam, Brass	2	
18	<b>R443102</b>	R01-188-0420, R22-11-AJD, R3217-5	Nut - 1/4-20 Yellow Zinc	2	
19	<b>R09030</b>	R32103-1, R32103-12, R32103-22	Nut - Wing 1/4	2	
20	<b>R237-143</b>		O-Ring	2	
21	<b>R100-6434</b>		Rod - Battery	1	
22	<b>R100-6435</b>	R56-7720	Post - Battery - Stainless	2	
23	<b>R301504</b>	R32127-24, R32146-17, R3296-16, R3296-42, R915661P, RM40333	Locknut - ESNA 1/4-20	2	
24	<b>R66-2630</b>		Latch - Seat	1	
25	<b>R3229-1</b>	R01-173-0406, R01-178-0408, R3229-25, R900015P	Bolt - 1/4-20 x 3/4 - Carriage	2	
26	<b>R150224</b>	R133-8896, R92-8990, R92-8991	Adjusters - Seat (Set of 2)	2	
27	<b>R92-8934</b>	R88-6330	Spring - Extension	1	
28	<b>R106-4643</b>		Rod-Prop,seat	1	
29	<b>R105-0464-03</b>		Seat Plate Assy	1	
30	<b>R68-5310</b>		Clip - Rod - Prop	1	
31	<b>R32128-33</b>		Nut - 1/4-20 Flanged Serr	2	

All original equipment manufacturers names and part numbers are used for identification purposes only, and we are in no way implying that our products are original equipment parts. Prices subject to change without notice.



# Replaces R&R Products Greens Max 2200LP Parts

Traction Unit  
Seat & Battery



Item No	R&R Part No.	OEM Part No.	Description	Qty Req	Order Quantity
32	<b>R1-523420</b>		Bumper - Rubber	2	
33	<b>R434024</b>	434024, R3274-12	Bolt - Soc HD Cap 5/16-18 x 3/4	8	
34	<b>R453009</b>	3256-3, R01-166-0400, R24-10-BD, R24-9-AD, R24H1136, R32-9650, R3256-2, R3256-23, R3256-67, R3290-217, R3556-3, R4-2390, R452006, R7-0152	Washer - Flat 5/16 SAE	8	
35	<b>R105-0466-03</b>		Plate-Seat, Upper	1	
36	<b>RMXB200GY</b>	R100-3187, R1001774, R104-4620, R21-4880, R351-59, R351-76, R4139438, R49-8130, R63-9410, R66-5400, R66172, R75-9190, R750105, R92-6280	Milsco Seat XB200 - Grey	1	
<i>Tech Note: This seat will not accept seat belts:</i>					
36	<b>R120-5179</b>		Large Seat Cover - Gray	1	
38	<b>R32144-10</b>	R32140-81, R32144-3, R34-140-AMVD	Bolt - 1/4-20 x 3/4 Serrated Hx Wshr	2	

All original equipment manufacturers names and part numbers are used for identification purposes only, and we are in no way implying that our products are original equipment parts. Prices subject to change without notice.



# Replaces R&R Products Greens Max 2200LP Parts

*Traction Unit  
Seat & Battery*



Item No	R&R Part No.	OEM Part No.	Description	Qty Req	Order Quantity
39	<b>R445795</b>	R30-4020, R32128-25, R444794	Nut - 5/16-18 Flanged	4	
40	<b>R105-0483</b>		Rod - Pivot - Seat	1	
41	<b>R32121-73</b>	R29-56-D, R32121-7, R95462	Pin - Roll	1	

All original equipment manufacturers names and part numbers are used for identification purposes only, and we are in no way implying that our products are original equipment parts. Prices subject to change without notice.