

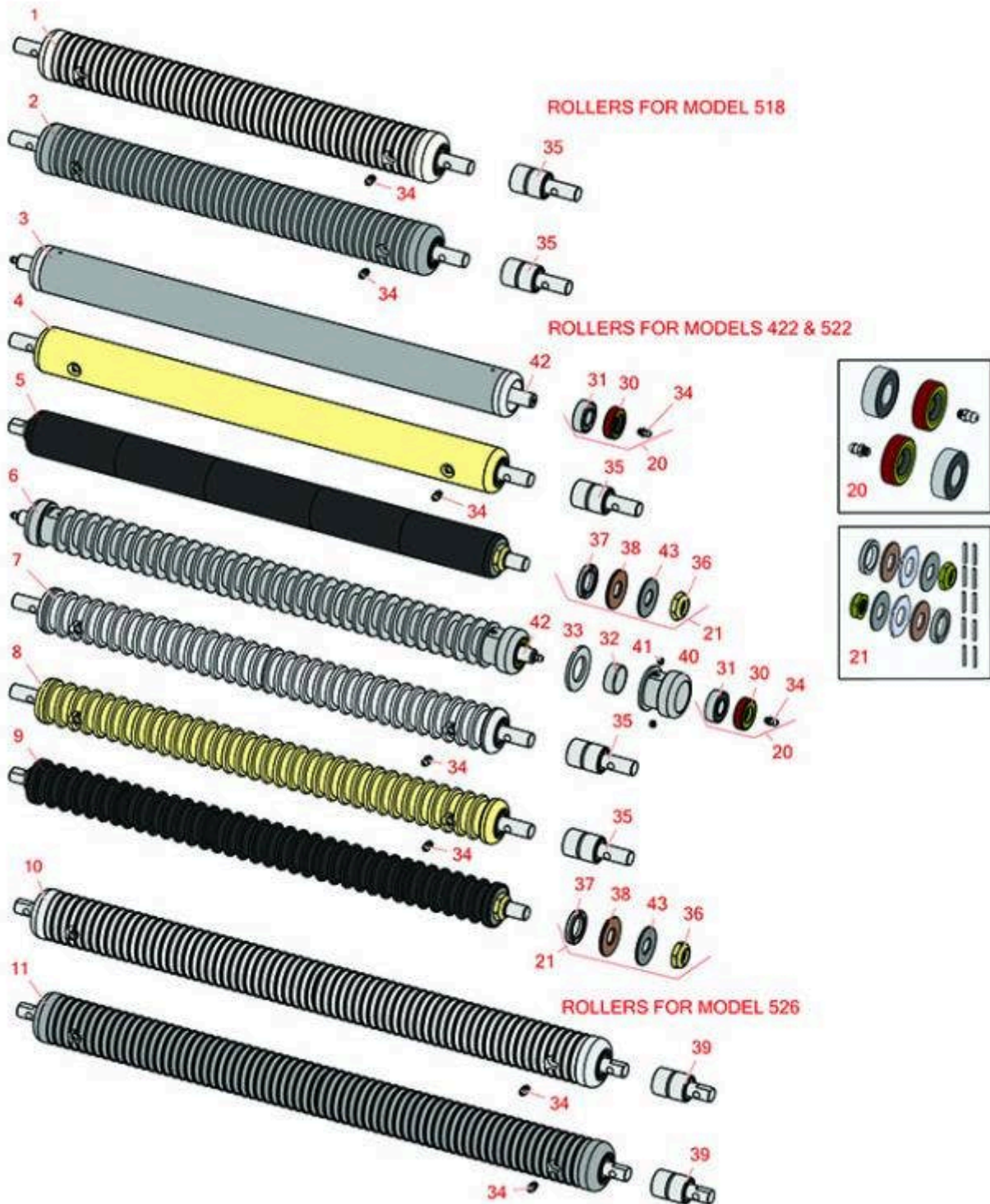

# Replaces Jacobsen Greens King 518

## Parts

Cutting Unit  
Rollers



All original equipment manufacturers names and part numbers are used for identification purposes only, and we are in no way implying that our products are original equipment parts. Prices subject to change without notice.



# Replaces Jacobsen Greens King 518

## Parts

Cutting Unit  
Rollers



Item No	R&R Part No.	OEM Part No.	Description	Qty Req	Order Quantity
---------	--------------	--------------	-------------	---------	----------------

### R&R Rollers to fit 518

1	<b>R101129</b>	68618	Roller - Grooved Machined Aluminum	1	
---	----------------	-------	------------------------------------	---	--

*Tech Note: Machined from solid aluminum, this roller uses greasable "water-pump" style bearings.:*

2	<b>R101130</b>	68616	Roller - Grooved Solid Steel	1	
---	----------------	-------	------------------------------	---	--

*Tech Note: Machined from solid steel, this heavy weight roller uses greasable "water-pump" style bearings.:*

### R&R Rollers to fit 422 & 522

3	<b>R158776</b>	158776, 162917	Roller - Smooth Tubular Steel	1	
---	----------------	-------------------	-------------------------------	---	--

*Tech Note: Constructed with a through shaft and greasable ball bearings.:*

4	<b>R101126</b>		Roller - Smooth Solid Steel	1	
---	----------------	--	-----------------------------	---	--

*Tech Note: Machined from solid steel, this heavy weight roller uses greasable "water-pump" style bearings.:*

5	<b>R101336</b>		Roller - Smooth UHMW Polyethylene	1	
---	----------------	--	-----------------------------------	---	--

*Tech Note: Machined from solid UHMW, this low maintenance roller uses a 1" solid stainless steel shaft and requires no grease. UHMW material prevents build-up of debris.:*

6	<b>R68527R</b>		Roller - Grooved Repairable Steel	1	
---	----------------	--	-----------------------------------	---	--

*Tech Note: Constructed with a through shaft and greasable ball bearings, this roller can be repaired by unscrewing the ends and replacing the series of washers and spacers.:*

7	<b>R101123</b>		Roller - Grooved Machined Solid Aluminum	1	
---	----------------	--	--	---	--

*Tech Note: Machined from solid aluminum, this lightweight roller uses greasable "water-pump" style bearings.:*

8	<b>R68577</b>	68577	Roller - Grooved Machined Solid Steel	1	
---	---------------	-------	---------------------------------------	---	--

All original equipment manufacturers names and part numbers are used for identification purposes only, and we are in no way implying that our products are original equipment parts. Prices subject to change without notice.



# Replaces Jacobsen Greens King 518

## Parts

Cutting Unit  
Rollers

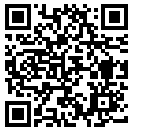

Item No	R&R Part No.	OEM Part No.	Description	Qty Req	Order Quantity
---------	--------------	--------------	-------------	---------	----------------

*Tech Note: Machined from solid steel, this heavyweight roller uses greasable "water-pump" style bearings.:*

9	<b>R101330</b>		Roller - Grooved UHMW Polyethylene	1	
---	----------------	--	------------------------------------	---	--

*Tech Note: Machined from solid UHMW, this low maintenance roller rotates around a 1" solid stainless steel shaft and requires no bearings or grease. Patented groove design and smooth UHMW material prevents build-up of debris.:*

### R&R Rollers to fit 526

10	<b>R101127</b>	67617	Roller - Grooved Machined Aluminum	1	
----	----------------	-------	------------------------------------	---	--

*Tech Note: Machined from solid aluminum, this roller uses greasable "water-pump" style bearings.:*

11	<b>R101128</b>	68628	Roller - Grooved Machined Solid Steel	1	
----	----------------	-------	---------------------------------------	---	--

*Tech Note: Machined from solid steel, this heavy weight roller uses greasable "water-pump" style bearings.:*

### Overhaul Kits

20	<b>R100130</b>	100130	Overhaul Kit - Roller	1	
----	----------------	--------	-----------------------	---	--

*Tech Note: Includes 2 ea.: R302-5 Grease Fittings, R303558 Bearings, & R305115 Seals:*

21	<b>R101395</b>	100139, 101395	Overhaul Kit - UHMW Roller	1	
----	----------------	-------------------	----------------------------	---	--

*Tech Note: Fits all R&R 2" Dia. Black UHMW Polyethylene Rollers. Includes 10 ea.: R150322 Roll Pins; 2 ea.: R3296-15 Locknuts, R150347T Teflon Seals, R150333 Thrust Washers, & R150334A Bronze Thrust Washers:*

### Other Parts Available

30	<b>R305115</b>	305115	Seal - Roller	2	
----	----------------	--------	---------------	---	--

31	<b>R303558</b>	303558	Bearing - Roller	2	
----	----------------	--------	------------------	---	--

32	<b>R150651</b>		Spacer - 2-3/8 Roller	34	
----	----------------	--	-----------------------	----	--

All original equipment manufacturers names and part numbers are used for identification purposes only, and we are in no way implying that our products are original equipment parts. Prices subject to change without notice.



# Replaces Jacobsen Greens King 518

## Parts

Cutting Unit  
Rollers

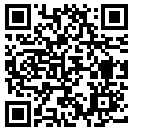

Item No	R&R Part No.	OEM Part No.	Description	Qty Req	Order Quantity
33	<b>R150652</b>	150652, 325262	Washer - 2 Roller	33	
34	<b>R302-5</b>	302-5, 471214, 471223, 471226	Fitting - Grease	2	
35	<b>R101481</b>	101481, 311839	Bearing - Roller	2	
<i>Tech Note: Fits R&amp;R Machined Grooved Roller &amp; Smooth (19 lbs) Roller:</i>					
36	<b>R3296-15</b>	3296-15, 367029, 444742	Locknut - 3/4-16 Nylon Jam	2	
37	<b>R150347T</b>		Seal - Nonstick Lip	2	
38	<b>R150334A</b>		Washer - Thrust SAE660 Bronze	2	
39	<b>R75-1290</b>	75-1290	Bearing - Roller	2	
40	<b>R150650</b>		Roller End - 2 Repairable	2	
41	<b>R150690</b>	150690, 415509	Screw - Set 1/4-20 x 1/4	4	
42	<b>R102030</b>	102030	Shaft - Front Roller	1	
43	<b>R150333</b>		Washer - Flat Keyed Outer SS	2	

All original equipment manufacturers names and part numbers are used for identification purposes only, and we are in no way implying that our products are original equipment parts. Prices subject to change without notice.