

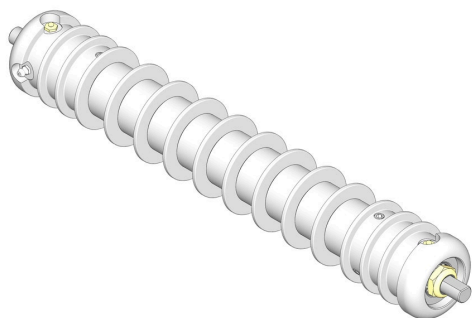

## Roller - Grooved Repairable Steel

### R101373



#### Details

Constructed with a through shaft and greasable ball bearings, this roller can be repaired by unscrewing the ends and replacing the series of washers and spacers.

#### Replaces

R&R Products	R2811028
--------------	----------

#### Specifications

Manufacturer	R&R Products
Roller Body	3 in
Diameter	
Weight (lbs)	16 lb

#### Fits Models

Jacobsen LF-1880

#### Replacement Parts

R500534	Bearing - with Cup
R2811030	Shaft
R150673	Washer - 3 Repairable Roller
R150676	Spacer - 2-3/4 Dia x 1-1/4 L
R100103	Roller End - Grooved
R150691	Screw - Set Nyloc 3/8-16 x 3/8
R170714	Fitting - Pressure Relief
R302-5	Fitting - Grease
R253-152	Seal - Inner Roller
R254-79	Cup - Bearing
R254-78	Tapered Bearing Cone
R5-4038	Sleeve - Wear Reel

**Complete Turf Equipment Ltd.**

4331 Oil Heritage Road Petrolia, N0N 1R0  
519-882-2008

<https://completeturf.rrproducts.com/>



# Roller - Grooved Repairable Steel

R101373



Shaft

R253-117

Seal - Outer Triple Lip

R3296-15

Locknut - 3/4-16 Nylon  
Jam