

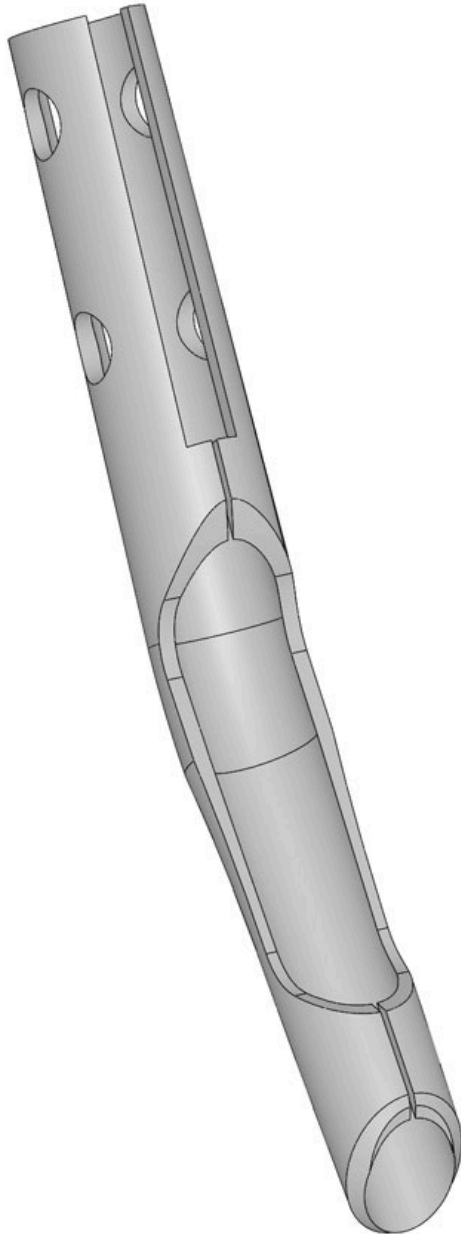

Spoon - 3/4CLOSED 5/16 Slot

R27300-106W



Specifications

| | |
|-------------------------------------|------------------|
| Manufacturer | R&R Products |
| A - Tine Type | Alloy Spoon |
| B - Tine Mounting Dia. | 1.000 in (25mm) |
| C - Tine Length | 8.5 in (216mm) |
| D - Tine Tip Outside (Hole) Dia. | .900 in (22.9mm) |
| E - Tine Tip Inside (Core) Dia. | .650 in (16.5mm) |
| F - Tine Wall Thickness | .104 in (2.6mm) |

Complete Turf Equipment Ltd.

4331 Oil Heritage Road Petrolia, N0N 1R0
519-882-2008

<https://completeturf.rrproducts.com/>