

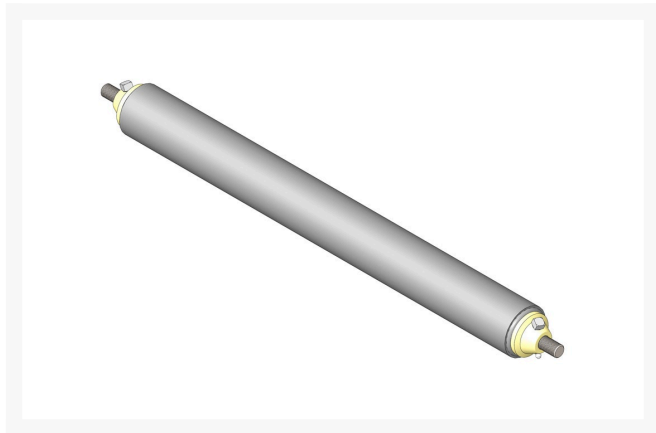

Roller - Smooth Tubular Steel

R600500



Details

Constructed with a through shaft, this heavy duty roller uses greasable tapered bearings for extended life.

Replaces

Brouwer	A61003
---------	--------

Specifications

Manufacturer	R&R Products
Overhaul Kit No.	R700505
Roller Body	3 in
Diameter	
Weight	18.5 lb

Fits Models

Brouwer 3/5/7 Gang Mower

Replacement Parts

R700505	Conversion Kit - Roller
R600105	Shaft - Roller
R700502	Retainer - Grease
R254-79	Cup - Bearing
R254-78	Tapered Bearing Cone
R328062	Seal - Roller
R700501	Roller End - Regreasable
R412063	Screw - Sq. HD. Set
R302-5	Fitting - Grease